

# vatti

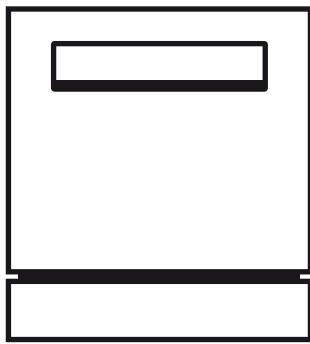

## DISHWASHER (DWBB7)



Instruction manual

PLEASE READ THE INSTRUCTION MANUAL CAREFULLY  
BEFORE USING THE PRODUCT AND KEEP IT PROPERLY!







*Thank you for choosing one of our products.*

*You are advised to read this manual carefully; it contains all the information you need about the right conditions for the proper, safe use of your dishwasher.*

*The individual sections are laid out to provide you with a step-by-step guide to all your appliance's functions; the texts are easy to understand and are complete with detailed illustrations.*

*Recommendations are given for the correct use of the baskets, spray arms, cavity, filters, washing programs, and for operating the controls. Following the cleaning instructions provided here will keep your dishwasher's performance at peak levels in the long term.*

*This user-friendly manual will provide answers to all your questions about use of the dishwasher.*



## PRECAUTIONS FOR USE

This manual forms an integral part of the appliance; it must always be kept intact together with the dishwasher for future reference. Before using the appliance, carefully read all the instructions contained in this manual. They contain important information for the installation, use and maintenance of the appliance. In the event of sale or transfer, ensure that the manual always accompanies the appliance.

 ACT OR OPERATION THAT MUST BE PROHIBITED	 MANDATORY ACT OR OPERATION
 <b>NOTICE</b>	IF THE OPERATION IS WRONG, IT MAY CAUSE PERSONAL AND PROPERTY DAMAGE



### PLACEMENT ENVIRONMENT AND WORKING SCENE

- THIS APPLIANCE IS INTENDED **FOR INDOOR USE IN A HOUSEHOLD ENVIRONMENT** AND SIMILAR SUCH AS STAFF KITCHENS OF SHOPS, OFFICES AND OTHER WORKPLACES, INSTITUTIONS, AND FOR THE USE BY GUESTS AT HOTELS, HOSTELS, BED AND BREAKFAST AND OTHER RESIDENTIAL FACILITIES.
- THIS APPLIANCE IS DESIGNED TO BE USED ONLY IN STATIONARY LOCATIONS.



### PRECAUTIONS ON DELIVERY

- DO NOT USE APPLIANCES WHICH HAVE BEEN DAMAGED DURING TRANSIT! IF IN DOUBT, CONSULT YOUR DEALER.
- DO NOT LEAVE THE DISCARDED PACKAGING MATERIALS UNSUPERVISED WITHIN THE HOME. DO NOT ALLOW CHILDREN TO PLAY WITH PACKAGING MATERIALS. SEPARATE THE VARIOUS MATERIALS WHICH MAKE UP THE PACKAGING AND TAKE THEM TO THE NEAREST SORTED WASTE COLLECTION CENTRE.
- DISHWASHER STORAGE TEMPERATURE SHOULD BE ABOVE ZERO DEGREES CELSIUS.
- AVOID LONG-DISTANCE TRANSPORTATION IN EXTREMELY COLD CLIMATES



### PRECAUTIONS FOR INSTALLING WATER AND ELECTRICITY CONNECTIONS

- THE APPLIANCE MUST BE CONNECTED TO THE WATER SUPPLY BY NEW HOSES; OLD HOSES MUST NEVER BE REUSED.
- THE APPLIANCE MUST BE INSTALLED AND CONNECTED IN ACCORDANCE WITH THE INSTRUCTIONS PROVIDED BY THE MANUFACTURER. INSTALLATION MUST BE PERFORMED BY A QUALIFIED TECHNICIAN, IN COMPLIANCE WITH THE REGULATIONS IN FORCE.
- THE NAME PLATE FEATURING THE TECHNICAL DATA, SERIAL NUMBER AND MARKINGS IS VISIBLY POSITIONED ON THE INNER EDGE OF THE DOOR. THE NAME PLATE MUST NEVER BE REMOVED.
- CHECK THAT THE VOLTAGE AND THE FREQUENCY OF THE MAINS MATCH THE RATINGS ON THE NAME PLATE OF THE APPLIANCE.



- THE APPLIANCE MUST BE PROVIDED WITH AN EARTH CONNECTION IN ACCORDANCE WITH THE ELECTRICAL SAFETY REGULATIONS IN FORCE. THE MANUFACTURER DECLINES ALL RESPONSIBILITY FOR DAMAGE TO PERSONS OR PROPERTY RESULTING FROM THE FAILURE TO EARTH THE APPLIANCE OR FROM A DEFECTIVE EARTH CONNECTION.
- THE PLUG ON THE SUPPLY CORD AND THE CORRESPONDING SOCKET OUTLET MUST BE OF THE SAME TYPE AND MEET THE REGULATION IN FORCE.  
DO NOT USE ADAPTORS OR SHUNT CONNECTIONS IN ORDER TO AVOID THE POSSIBILITY OF OVERHEATING OR BURNING.
- THE PLUG OF THE APPLIANCE MUST BE ACCESSIBLE AFTER INSTALLATION. NEVER DISCONNECT THE PLUG BY PULLING ON THE POWER CORD.



#### **PRECAUTIONS FOR DAILY USE AND MAINTENANCE**

- ONLY USE DETERGENT AND RINSE AID FORMULATED FOR DOMESTIC DISHWASHERS. DO NOT USE WASHING-UP LIQUID.
- DO NOT USE COMMERCIAL OR INDUSTRIAL DETERGENTS AS THESE MAY CAUSE DAMAGE, AND THERE IS A RISK OF A SEVERE EXPLOSIVE CHEMICAL REACTION (SUCH AS AN EXPLOSIVE OXYHYDROGEN GAS REACTION).
- DO NOT FILL THE RINSE AID RESERVOIR WITH POWDER OR LIQUID DETERGENT. THIS WILL CAUSE SERIOUS DAMAGE TO THE RESERVOIR.
- INADVERTENTLY FILLING THE SALT RESERVOIR WITH POWDER OR LIQUID DISH - WASHER DETERGENT WILL DAMAGE THE WATER SOFTENER. MAKE SURE YOU HAVE PICKED UP THE CORRECT PACKET OF DISHWASHER SALT BEFORE FILLING THE SALT RESERVOIR!
- ONLY USE SPECIAL COARSE GRAINED DISHWASHER SALT FOR REACTIVATION. DO NOT USE OTHER SALTS SUCH AS COOKING SALT, AGRICULTURAL GRADE OR GRITTING SALT. THESE MAY CONTAIN INSOLUBLE ADDITIVES WHICH CAN IMPAIR THE FUNCTIONING OF THE WATER SOFTENER. SOME DETERGENTS ARE STRONGLY ALKALINE. AVOID CONTACT WITH THE SKIN AND EYES.
- DETERGENTS CAN BE EXTREMELY DANGEROUS IF SWALLOWED. THEY CONTAIN SUBSTANCES CAPABLE OF CAUSING PERMANENT DAMAGE TO THE MOUTH AND THROAT, AND EVEN LEADING TO SUFFOCATION. OBSERVE ALL THE SAFETY INSTRUCTIONS ON THE PACKAGING OF THESE PRODUCTS. DO NOT DRINK THE WATER RESIDUES WHICH MAY BE PRESENT INSIDE THE DISHES OR APPLIANCE AT THE END OF THE WASHING PROGRAM.  
THE COLLAPSIBLE CUP HOLDER IS USED TO PLACE TEACUPS, GLASSES AND LONGER COOKING
- UTENSILS, CHOPSTICKS, SPOONS, ETC. DO NOT PRESS THE HOLDER HARD OR USE IT TO SUPPORT YOUR WEIGHT TO AVOID BREAKING.  
KNIVES OR OTHER SHARP-ENDED COOKING TOOLS MUST BE PLACED IN THE CUTLERY BASKET
- BLADE-DOWN, OR LAID HORIZONTAL IN THE TOP BASKET. TAKE CARE NOT TO CUT YOURSELF AND ENSURE THAT THEY DO NOT PROJECT FROM THE BASKET.



- PLEASE CLOSE THE DISHWASHER DOOR BEFORE OPERATING THE DISHWASHER. WHEN OPENING AND CLOSING THE DOOR, PLEASE BE CAREFUL NOT TO PINCH YOUR FINGERS TO AVOID INJURY.
- DURING THE RUNNING OF THE PROGRAMME OR JUST AFTER THE PROGRAMME ENDS, THE DISHWASHER FILTER IS IN A HIGH TEMPERATURE STATE, PLEASE DO NOT TOUCH THE FILTER WITH YOUR HANDS TO AVOID BURNING YOUR HANDS.
- DISHES CAN BE VERY HOT AT THE END OF THE PROGRAMME. ALLOW THEM TO COOL UNTIL THEY ARE COMFORTABLE ENOUGH TO HANDLE BEFORE UNLOADING.
- LEANING OR SITTING ON THE DISHWASHER DOOR WHEN OPEN MAY CAUSE THE APPLIANCE TO OVERTURN. NEVER LEAVE THE DISHWASHER DOOR OPEN; PEOPLE MIGHT TRIP OVER IT.
- IN ORDER TO ENSURE THE WASHING EFFECT, IT IS RECOMMENDED TO CLEAN THE MANUAL FILTER ONCE EVERY THREE DAYS (AT LEAST ONCE A WEEK), AND INSTALL THE FILTER IN PLACE AS REQUIRED AFTER CLEANING.
- BEFORE CLEANING THE DISHWASHER, PLEASE UNPLUG THE POWER PLUG AND TURN OFF THE WATER INLET VALVE OR TAP; IF THE DISHWASHER IS NOT USED FOR A LONG TIME, PLEASE UNPLUG THE POWER PLUG AND TURN OFF THE WATER INLET VALVE OR TAP.



#### **PROHIBITED ITEMS FOR DAILY USE AND MAINTENANCE**

- WHEN THE DISHWASHER IS RUNNING, IT IS FORBIDDEN TO MANUALLY ADD WATER, OTHERWISE IT MAY CAUSE THE MACHINE TO OVERFLOW AND CAUSE DANGER.
- WHEN THE DISHWASHER IS RUNNING, IT IS FORBIDDEN TO MOVE OR TILT THE MACHINE, OTHERWISE IT MAY CAUSE WATER LEAKAGE, ELECTRIC LEAKAGE, AND DANGER.
- DO NOT POUR OR POUR WATER INTO THE DISHWASHER, AS IT MAY CAUSE FIRE AND ELECTRIC SHOCK.
- DO NOT OPEN THE DOOR FORCIBLY WHILE THE DISHWASHER IS RUNNING, BECAUSE THE WASHING WATER, HOT STEAM, AND THE INSIDE OF THE DISHWASHER ARE ALL HIGH TEMPERATURE, WHICH MAY CAUSE BURNS. DURING WASHING, DO NOT TOUCH THE HOT WATER FROM THE DRAIN.
- DO NOT INTRODUCE SOLVENTS SUCH AS ALCOHOL OR TURPENTINE IN THE APPLIANCE, AS THIS MAY CAUSE AN EXPLOSION.
- DO NOT LOAD DISHES THAT ARE SOILED WITH ASH, WAX OR PAINT.
- DO NOT TOUCH, PLUG OR UNPLUG THE POWER PLUG WITH WET HANDS.
- IT IS FORBIDDEN TO DAMAGE, PROCESS, BEND, PINCH, TWIST, PULL, BIND THE POWER CORD AND PLUG, AND DO NOT PLACE HEAVY OBJECTS ON THE POWER CORD AND PLUG.
- UNAUTHORIZED CHANGES TO THE CONTROL KEYS ARE PROHIBITED.



#### **FAULT OR DAMAGE**

- IN THE EVENT OF A FAULT, DISCONNECT THE DISHWASHER FROM THE ELECTRICAL POWER SUPPLY AND SHUT OFF THE WATER TAP.
- IN THE EVENT OF DAMAGE TO THE SUPPLY CORD, HAVE IT REPLACED BY THE MANUFACTURER OR AN AUTHORIZED TECHNICAL SERVICE CENTRE.



- THE DISHWASHER MEETS ALL THE REQUIREMENTS SET OUT BY THE REGULATIONS IN FORCE CONCERNING SAFETY AND ELECTRICAL EQUIPMENT. ANY TECHNICAL CHECKS SHOULD BE CONDUCTED EXCLUSIVELY BY TRAINED AND AUTHORISED TECHNICIANS: **REPAIRS CARRIED OUT BY UNAUTHORISED PERSONS WILL INVALIDATE THE WARRANTY, AS WELL AS POSING A POTENTIAL HAZARD TO THE USER.**



#### DISPOSAL OF OLD MACHINES

- **IN ACCORDANCE TO ART. 26 OF THE LEGISLATIVE DECREE 14 MARCH 2014, NR. 49 "IMPLEMENTATION OF THE DIRECTIVE 2012/19/EU ON WASTE OF ELECTRICAL AND ELECTRONIC EQUIPMENT (WEEE)".**
- THE SYMBOL OF A CROSSED OUT WHEELIE BIN  ON THE DEVICE OR PACKAGE SHOWS THAT THE PRODUCT MUST BE COLLECTED SEPARATE FROM OTHER WASTE, AT THE END OF ITS SERVICE LIFE. THEREFORE, THE USER HAS TO TAKE ANY EQUIPMENT THAT HAS REACHED THE END OF ITS SERVICE LIFE TO LOCAL WASTE DISPOSAL CENTRES FOR ELECTRICAL AND ELECTRONIC EQUIPMENT WASTE.



#### SPECIAL CONSIDERATIONS FOR CHILDREN

- DO NOT ALLOW CHILDREN TO PLAY WITH THE APPLIANCE
- THIS DISHWASHER MUST BE USED BY ADULTS. USE OF THE APPLIANCE BY CHILDREN AGED FROM EIGHT YEARS AND PERSONS WITH REDUCED PHYSICAL, SENSORY OR MENTAL CAPABILITIES OR LACK OF EXPERIENCE AND KNOWLEDGE IS ONLY PERMITTED UNDER THE SUPERVISION OF A PERSON RESPONSIBLE FOR THEIR SAFETY.
- CLEANING AND REGULAR MAINTENANCE OF THE APPLIANCE BY CHILDREN IS ONLY PERMITTED UNDER THE SUPERVISION OF A PERSON RESPONSIBLE FOR THEIR SAFETY.
- KEEP CHILDREN AWAY FROM THE DISHWASHER WHEN THE DOOR IS OPEN. ALWAYS CHECK THAT THE DETERGENT RECEPTACLE IS EMPTY AFTER COMPLETION OF THE WASH CYCLE.

# INSTALLATION INSTRUCTION

### PRODUCT DIMENTIONS AND HOLE SIZE(UNIT:MM)

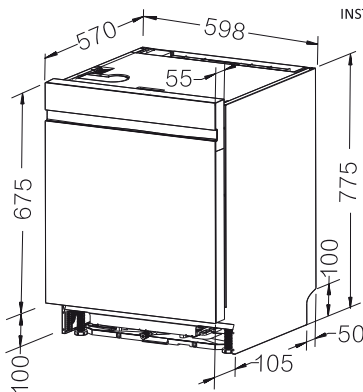

NOTE: AFTER THE DISHWASHER DOOR IS OPENED 90°, THE DOOR EXTENDS OUTWARD TO A DEPTH OF 620MM.

**HOLE SIZE (UNIT: MM)**

THE DIMENSIONS OF THE BUILT-IN CABINET ARE: 600MM WIDE\*780MM HIGH\*580MM DEEP.  
THE OPENING HOLE SIZE OF THE CABINET BOTTOM PLATE NEXT TO IT IS: 70\*70MM.

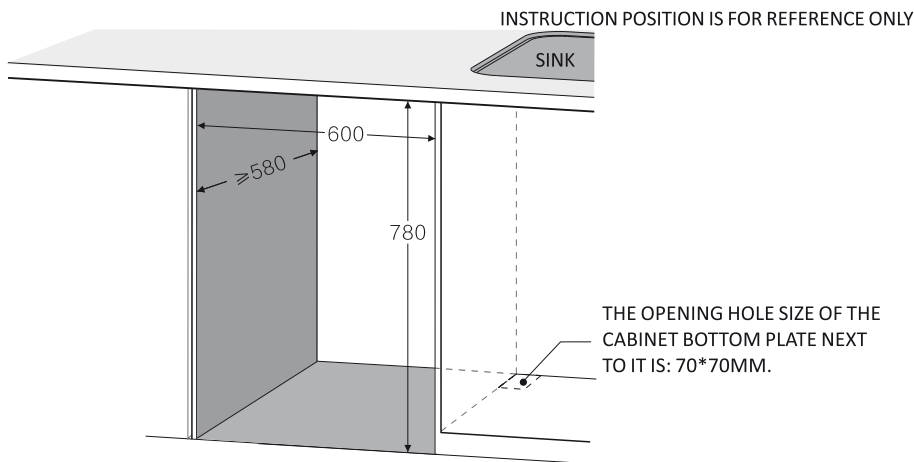

- It is necessary to ensure that the installation position of the cabinet avoids obstacles such as water pipes and gas pipes, otherwise it will affect the safety of product installation and use.
- The bottom support legs of this product can adjust the height, and the height adjustment range is 0~40mm.



## HOLES OPENING

### Holes of inlet pipe, outlet pipe and socket

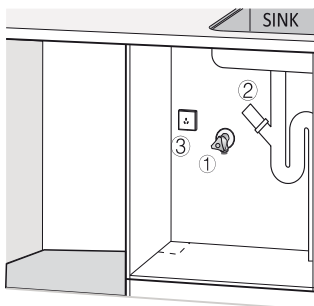

- ① Inlet pipe interface reserved:  
Angle valve 4 (G1/2") external  
thread length is not less than  
10mm;

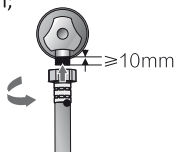

- ② Sewer Pipe(three way pipe),  
the pluggable length of the sewer  
pipe must be  $\geq 28\text{cm}$  and the  
inner diameter is 4cm.

- ③ The power socket must be  
located in the cabinet next to the  
dishwasher installation  
cabinet and reliably grounded,  
220 -240V/50Hz, 10A;



The power socket must be located in the cabinet next to the dishwasher installation cabinet and be reliably grounded, and cannot be installed behind the dishwasher.

### The maximum distance between the water pipe and the power cord from the side of the dishwasher

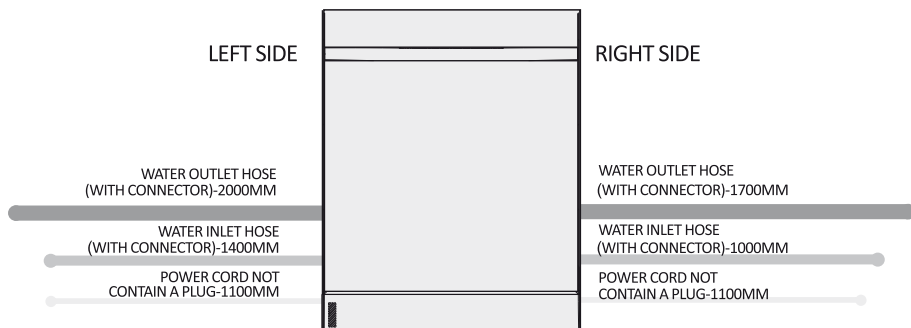

REMARKS: The above data is measured manually and there may be errors. Please refer to the actual situation.



## BUILT-IN INSTALLATION

### Level the dishwasher

- ① Measure the height from the floor to the bottom edge of the cabinet countertop;
- ② Measure the height from the floor to the upper edge of the top of the dishwasher;
- ③ Adjust the bottom support legs of the dishwasher to the appropriate height (the gap between the lower edge of the cabinet table and the upper edge of the dishwasher should be at least 3 mm)

Tips:

- Use a flat screwdriver or wrench to adjust the height of the support legs on both sides of the front end of the dishwasher. The height of the rear support foot can be adjusted by twisting the cross nut in the middle of the front end of the base.
- The height adjustment range of the support foot is 0-40mm. Please ensure that the machine is adjusted to a level before use (you can use a spirit level to measure or use a tape measure to measure the height of the four sides to be consistent).
- Please ensure that the dishwasher is placed horizontally, otherwise the machine will not be placed smoothly, which may affect the normal operation of the machine or even cause damage to the machine. and the upper edge of the dishwasher should be at least 3 mm)

### Install skirting boards

- ① The accessories of this machine include a skirting board. First install the skirting board hook in the accessory bag on the skirting board, and then install the skirting board on the skirting at the bottom of the dishwasher. (As shown on the right)
- ② If the cabinet comes with its own skirting board, you can install the cabinet skirting board after the machine is installed and fixed. Note that the cabinet skirting board needs to be cut and processed to prevent interference with the dishwasher door.

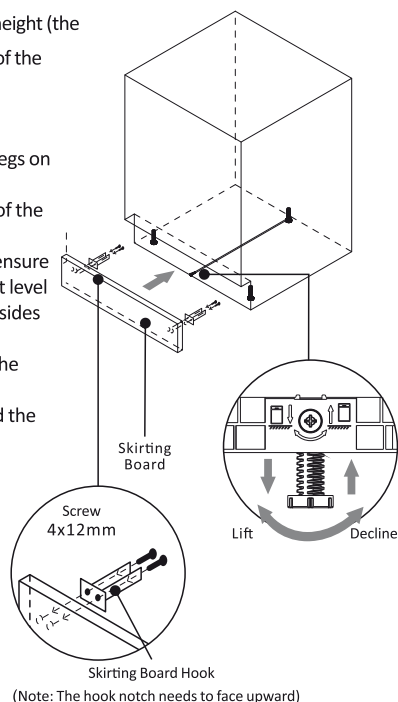

### Attach moisture-proof tape

Paste moisture-proof tape on the top and inner walls of both sides of the cabinet door opening. The moisture-proof tape is an original accessory.

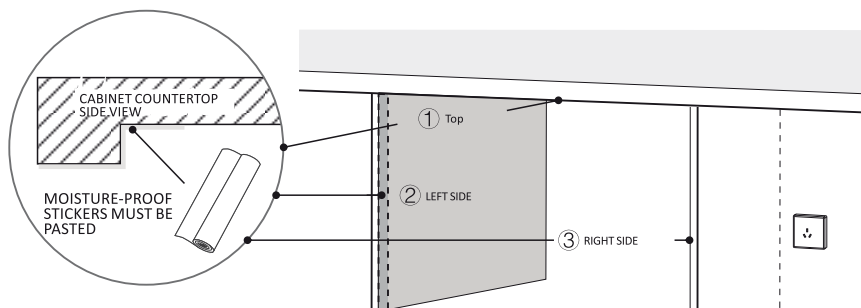





## Water inlet pipe connection

Connect the water inlet pipe to the water inlet pipe interface on the back of the dishwasher. Tighten the water inlet pipe connector clockwise to avoid water leakage.

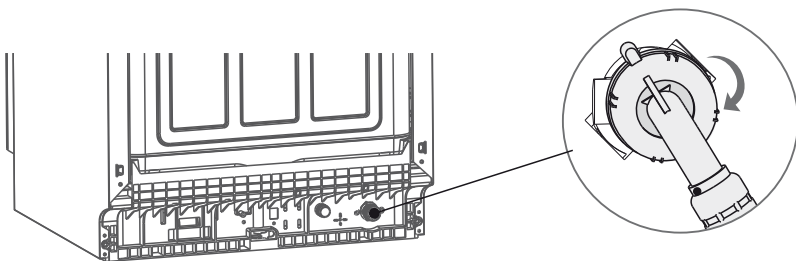

The water inlet pipe is an original accessory, and it is strictly forbidden to use an aged or damaged water inlet pipe; check the connecting rubber gasket is complete before installation.

## Water outlet pipe connection

- ① Completely insert the right-angled end of the dishwasher drain pipe into the drain pipe interface on the back of the dishwasher, and tighten the connection with a pipe clamp to prevent the drain pipe from loosening and leaking. (Before connecting, please confirm that the direction of the drain pipe is consistent with the direction of the sewer to avoid bending of the drain pipe and affecting drainage)
- ② Completely insert the dishwasher drying drain pipe into the drying drain pipe interface on the back of the dishwasher, and tighten the connection with a pipe clamp to prevent the drain pipe from loosening and leaking.

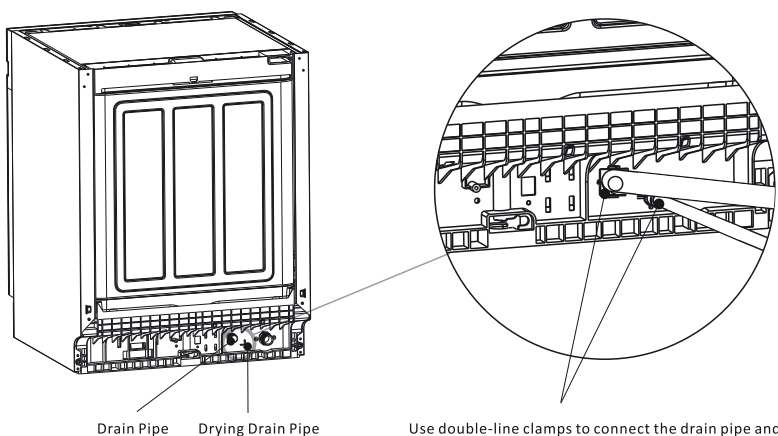



## Push the dishwasher into the opening position

- ① Before pushing the dishwasher into the opening position, first pass the inlet pipe, drain pipe and power cord through the cabinet partition, pull the inlet pipe, drain pipe and power cord to ensure that they are not knotted or entangled;
- ② Push the dishwasher into the reserved cabinet opening position. When the dishwasher is pushed in, the water hose and the power cord need to be pulled out at the same time.

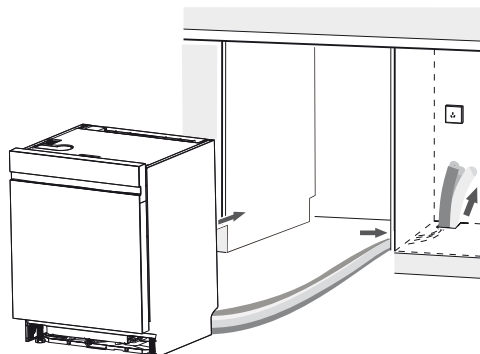

### ⚠ NOTICE

- ① If the dishwasher cannot be properly pushed into the slot, the intake, drain and power cords may not be properly aligned. Pull the dishwasher out and re-arrange the inlet, drain and power cord. Do not force the dishwasher into force, such as the dishwasher squeeze, drain and power cord, the dishwasher will not work properly.
- ② When inserting the dishwasher, do not push the dishwasher hard to cause the dishwasher to be embedded too deep, because it may cause the cabinet to push the dishwasher door, resulting in the door not being closed tightly, the dishwasher cannot be started, or causing the washing process to be damaged or steam escapes.
- ③ Do not pull hard on the dishwasher water pipe to avoid loosening the joint and leaking water. Do not squeeze the dishwasher body into the water pipes of the dishwasher, so as not to affect the water supply and drainage of the dishwasher, or even cause the water pipes to crack and leak.

## Connect water inlet pipe to tap

There are two connection methods for water inlet

Method 1: Connect to the faucet (via angle valve)

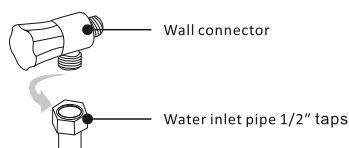

### ⚠ NOTICE

- When the water inlet pipe is connected to the water inlet connector (angle valve), make sure that the joint is tightened and there is no leakage of water droplets. Do not use tools such as wrenches to disassemble the water inlet pipe to prevent water leakage caused by thread slippage of the water inlet pipe joint;
- Do not connect the drain pipe to the sewage processor, which may cause the drain pipe to be blocked;
- It is recommended not to connect the drain pipe of the dishwasher to the drain pipe of other machines with a drain pump, because when other machines drain, sewage may flow into the drain pipe of the dishwasher.

Method 2: Connect with the water inlet tee  
(through both ends of the water pipe interface)

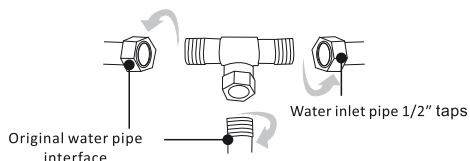



## Connect water outlet pipe to tap

- ① Press the icon position to install the drain hose hook (distance from the ground 400-1000mm), fix it with self-tapping screws, and fit the drain into the hook slot.
- ② The drain end of the drain pipe is inserted into the sewer pipe (a 4 cm inner diameter tee pipe or an upright pipe). The drain pipe can not be discounted. It is not recommended to extend it. (If the drain pipe must be lengthened, the total length should not exceed 4 meters, otherwise the washing effect may be affected).
- ③ Connect the inlet pipe to the reserved inlet port to ensure that the joint is tight and there is no water leakage (the minimum bend radius of the inlet pipe is 200mm, and the length of the inlet port connection thread is not less than 10mm).
- ④ Make sure that the power outlet is grounded reliably and connected to a power source.

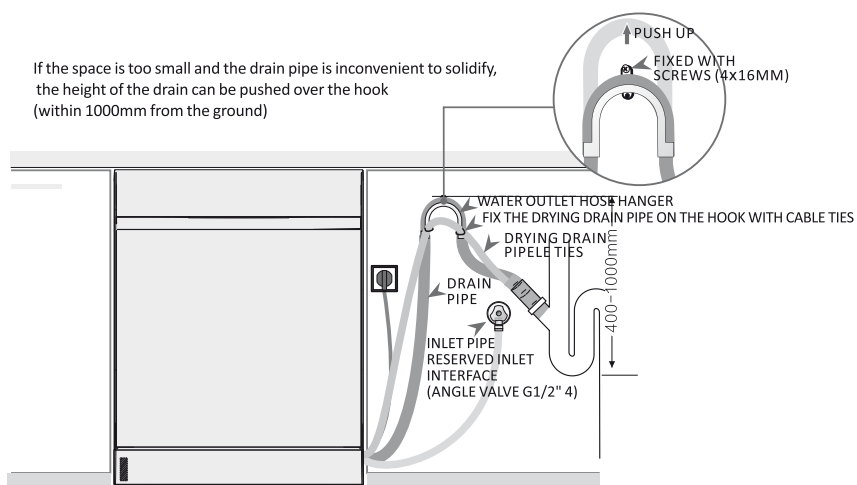

### NOTICE

- ① The end of the drain pipe must not be immersed in water to prevent sewage from flowing back.
- ② Never connect the drain pipe to the sewage treatment device, as this may cause the drain pipe to become blocked.
- ③ It is recommended not to connect the dishwasher drain pipe to the same interface as the drain pipe of other machines with drainage pumps, because sewage may flow into the dishwasher drain pipe when other machines drain water.

## Connect to the power

The power outlet must be reliably grounded  
(220-240V/50Hz, 10A)

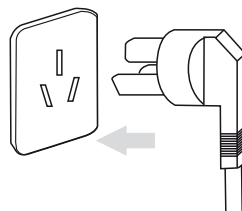



## Run the machine

- ① Before fixing the dishwasher, please run any washing program of the dishwasher to ensure that the dishwasher can operate normally;
- ② Check whether the inlet and outlet pipes are connected in place, and ensure that the inlet and outlet pipes are not squeezed, deformed, or leaked;
- ③ Check whether the dishwasher is placed horizontally, otherwise it will cause water overflow or even electric leakage. The vent area at the bottom of the dishwasher should be kept clear of carpet;

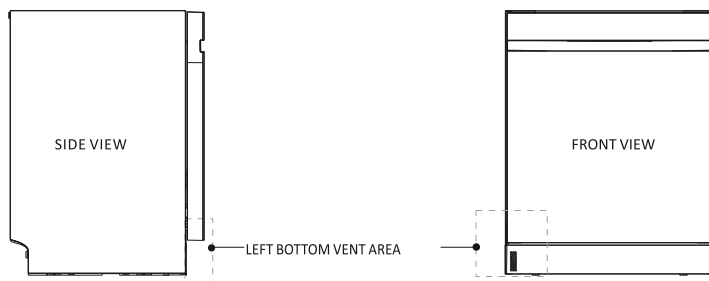

Reminder: When the air vent area is drying, the hot and humid steam of the inner tank will be discharged. After being discharged outside the machine, it may condense into water droplets when it encounters cold air. This is a normal phenomenon.

## Fix the dishwasher on the cabinet

- ① Open the door of the dishwasher, and use a flathead screwdriver to pry off the installation covers on the installation holes (one on each side);
- ② Put the screws through the holes in the door frame of the dishwasher and fix them on the side panel of the cabinet. The holes on the left and right sides need to be fixed;
- ③ Install the cover on the screw hole cover in the door frame of the dishwasher respectively (the installation cover is an original accessory).

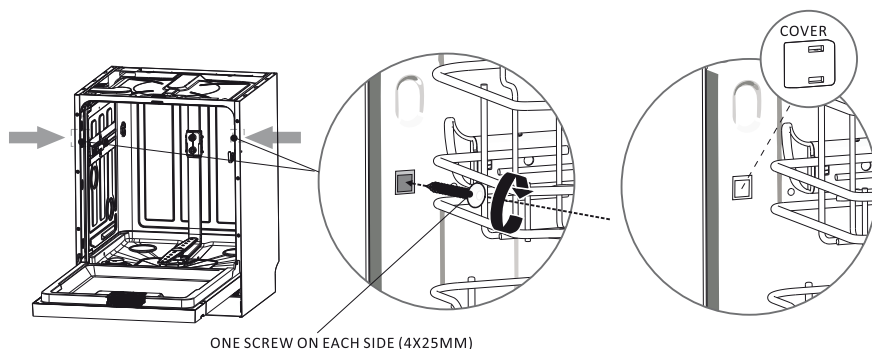

### NOTICE

When the water enters for the first time, the water in the dishwasher is yellowish, which is a normal phenomenon. This is the result of long-term soaking of soft water substances in the residual water in the water softener, and it does not affect normal use.



## ADDING DISHWASHING POWDER OR DISHWASHING BLOCK

Function: Special dishwashing powder/dishwashing block, which can decompose the oil stains on the tableware and remove food residues. Be sure to add dishwashing powder/block every time you use the dishwasher (except sanitizer wash or self-cleaning).

Dosage of dishwashing powder: Add according to the degree of dirt and the amount of tableware. If there is a lot of oil, the recommended dosage is: 25g. You can also refer to program table, and add appropriately according to the program used.

Add Method

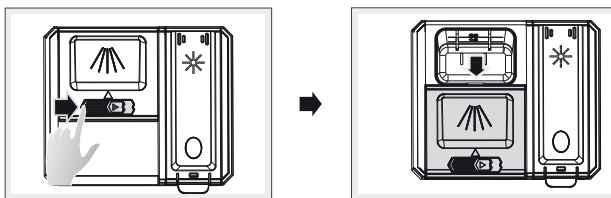

- ① Turn the switch of the dishwashing powder adder to the right, and the lid of the dishwashing powder adder will pop open automatically. Please ensure that the dishwashing powder compartment is dry, otherwise, when adding dishwashing powder, it may cause the dishwashing powder to agglomerate and affect the washing effect.

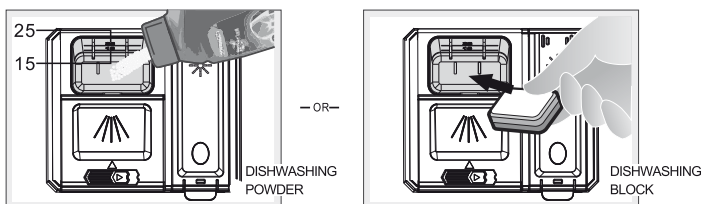

- ② Add dishwashing powder or dishwashing blocks to the dishwashing powder adder, (when using a short washing program, such as: quick wash, it is not recommended to use dishwashing blocks. If the program washing time is too short, the dishwashing blocks will not be able to dissolve completely or cannot be rinsed off).

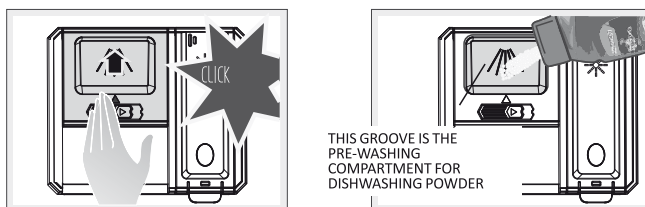

- ③ Push and press the lid of the dishwashing powder dispenser box until a "click" sound is heard and the buckle is fastened.
- ④ If the tableware is full or oily, you can add about 5g of dishwashing powder to the pre-wash compartment of the dishwashing powder box cover to enhance the cleaning effect.



1. Disinfection washing is suitable for long-term storage of clean tableware or tableware disinfection after hand washing, Please do not add dishwashing powder/dishwashing tablets.
2. Do not use high-foaming detergents such as detergents and household detergents, as they may damage the dishwasher.



DO NOT USE  
DISH SOAP



## ADDING RINSE AID

Function: To ensure the drying effect of the tableware and the inner tank, making the tableware more shiny and as new as time goes by.

### Add Method

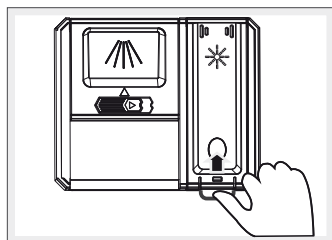

- ① Open the lid of the rinse aid cartridge upwards;

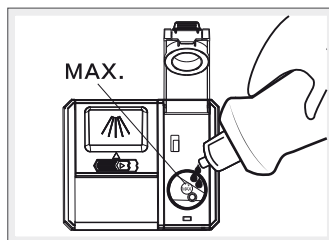

- ② Pour the rinse aid into the hole of the rinse aid adder to the highest mark (the amount of rinse aid should not be higher than the MAX. indicator line). If there is any spillage, it must be wiped clean (Note: Excessive rinse agent spillage will produce a lot of foam during the washing process, resulting in damage to the dishwasher);

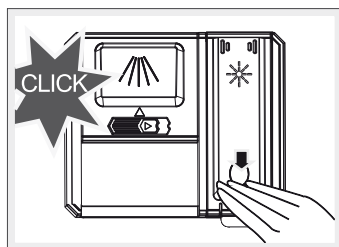

- ③ Fasten the lid of the rinse aid cartridge until a "click" sound is heard and the buckle is fastened.;



If you use all-in-one dishwashing blocks/ dishwashing beads/dishwashing liquid and other washing consumables, in order to achieve the ideal drying effect, please use rinse aid at the same time, otherwise it may affect the drying effect, please consult the washing consumables manufacturer for more details.

### Reminder:

When the lack of rinse aid indicator is on (the screen displays "Lack of rinse aid"), it indicates that there is a lack of rinse aid, please add rinse aid in time, otherwise the drying effect will be affected. Rinse aid is a consumable that is added once and used many times.



## ADDING SPECIAL SALT

Function: The machine needs to add special salt to have the ability to soften water.

Add Method:

- ① Rotate counterclockwise (as indicated by the arrow ① in the picture), and lift up the water softener cover after loosening;
- ② Add special salt into the water softener with a salt bucket (as shown in Figure ②), and the salt bucket is an original accessory;
- Remarks: The maximum capacity of the special salt for the salt hopper is about 600g, and the total capacity of the salt bin is 1000g. In order to prevent the salt water from overflowing during the addition process and corrode the inside of the dishwasher, the recommended amount of special salt to add is: 1 salt hopper (about 600g);
- ③ If you are using the dishwasher for the first time, you need to add 300ml of water (about half a salt hopper, as shown in Figure ③), and then special salt;
- ④ Tighten the water softener cover clockwise (indicated by the arrow).

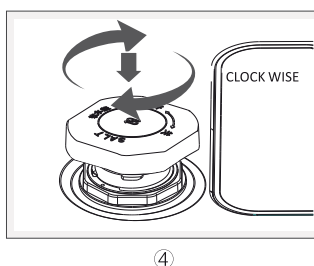
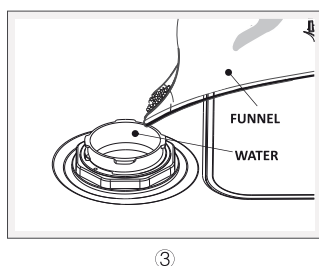
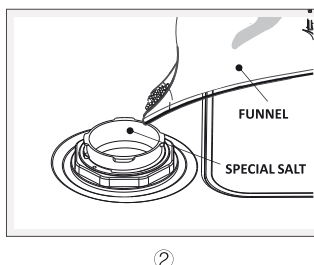
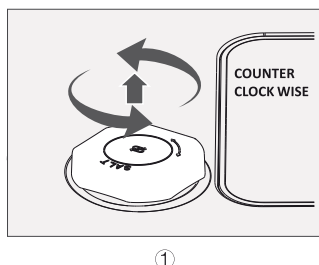

Reminder:

When the lack of special salt indicator is on (the screen displays "salt shortage"), it indicates that there is a lack of special salt, please add special salt in time, otherwise it will affect the water softener and lose the ability to soften water, and the inner tank and tableware are prone to scaling. Salt is a consumable that is added once and used in multiple places.



- Do not add other substances to the water softener, so as not to damage the components;
- If there is a small amount of water overflowing during the process of adding salt, it is a normal phenomenon;
- After adding salt, please run any washing program to ensure that the spilled salt and overflowing salt water are washed away, so as to prevent the high concentration of salt water from corroding the inside of the dishwasher;
- After adding a sufficient amount of special salt, the salt shortage indicator light will not go out immediately;
- If you use all-in-one dishwashing blocks/dishwashing beads/dishwashing liquid and other washing consumables, in some areas with high water hardness, if the inner tank and tableware are scaled, please use special salt at the same time to upgrade the machine. Soft water effect, please consult the manufacturer of washing consumables for details.



## SUGGESTIONS FOR CLEANING TABLEWARE OF DIFFERENT MATERIALS

### Dishwasher-safe tableware



Ceramic Tableware



Glass Tableware



Stainless Steel Tableware



Products such as precious metals, aluminum and colored glazes  
Dishwasher finish may deteriorate

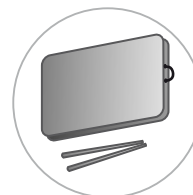

Wooden product  
Washing at high temperature may cause deformation, cracking and other problems.  
In addition, the drying performance of wood products are poor, cannot be stored in the dishwasher

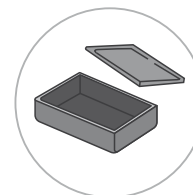

Plastic products  
Washing at high temperature may cause deformation, cracking and other problems.



Lighter products such as rags and sponges  
Water jets may cause objects to fall and affect the operation of the machine

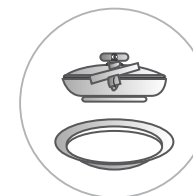

Iron products, aluminum products, coated non-stick pans  
May rust or chemically react with the coating after washing

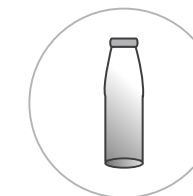

Products with thinner openings  
Such as glass bottles, etc., it is not easy to spray to the inside, and it may not be washed clean

### Reminder:

1. The test tableware is standard tableware (ceramic tableware, glass/ceramic cups, stainless steel chopsticks, etc.). If you place wok utensils such as frying pans, or if the size of the tableware is too large, you need to reduce the amount of tableware placed.
2. Before use, please check whether the tableware is suitable for washing in the dishwasher. If not, please do not use the dishwasher. Note that wooden and bamboo tableware are not recommended to be washed in the dishwasher. High temperature may cause them to deform and crack. In addition, due to their strong water absorption, they are not suitable for storage in the dishwasher. Please take them out in time after washing.





## DETAIL TABLE WARE PLACEMENT INSTRUCTION

### How to use the movable shelf with upper basket

As shown in the picture, the dark shelf marked on the upper basket can be folded along the direction of the arrow. After folding, larger tableware/cooking utensils can be placed, such as frying pans, pans, spatulas, etc.

- ① Open the movable shelves on both sides of the basket (picture A) to place big noodle bowls.

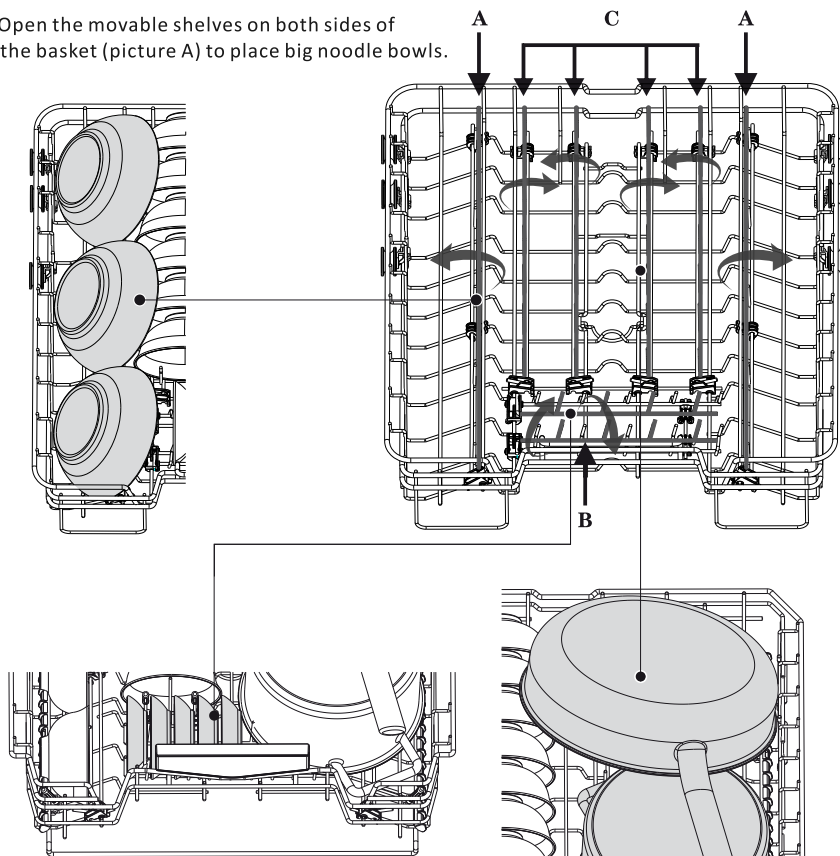

- ② Put down the movable shelf at the front of the basket (picture B) to place standard bowls.

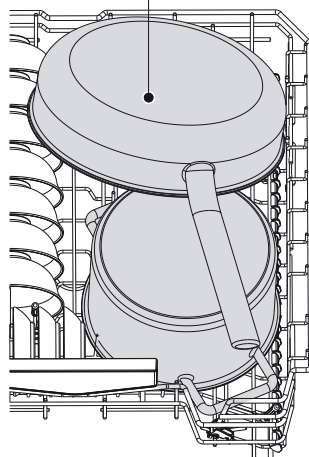

- ③ Lay down the movable shelves in the middle and both sides of the basket (A, C in the picture), and you can place a frying pan.

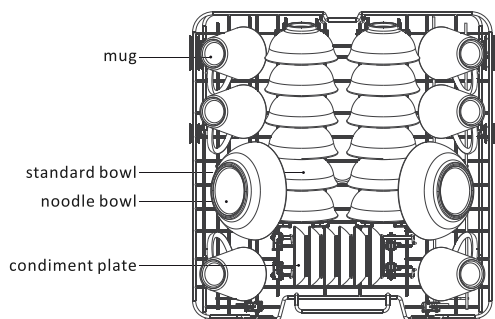

Upper basket standard tableware layout

Remarks: Please refer to the instruction manual for the standard tableware placement method (performance test tableware placement method).

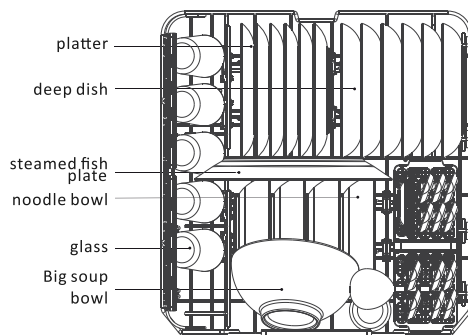

Lower basket standard tableware layout



Extra long chopsticks, spatulas and other items need to be placed on the cutlery bracket. Do not put them directly into the upper or lower basket to prevent them from falling during the washing process and blocking the spray arm, causing the washing to be incomplete.

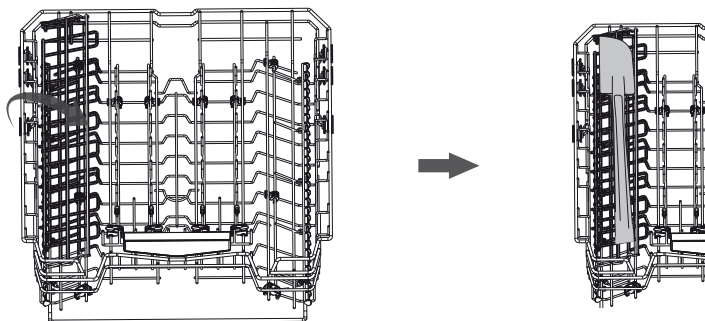

## REMINDER OF TABLEWARE PLACEMENT

1. Please remove larger or solid residues (toothpicks, fish bones, bones, thinner vegetable seasonings, etc.) before placing. This type of residue does not exit the dishwasher and collects in the filter, which requires more frequent cleaning and, if left unwashed for a long time, may build up odors.

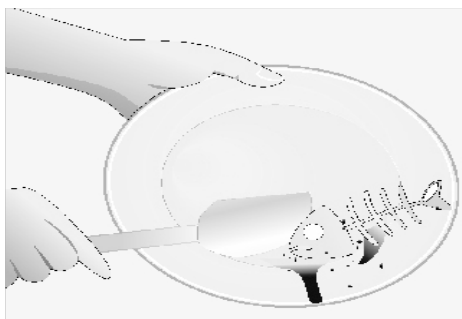



2. When the tableware is placed, the opening (dirty side) of the tableware should be placed downwards, so that the water flow of the spray arm can wash the tableware, and the sewage can slide down quickly. If the tableware is facing upwards, it will cause unclear washing, and even cause water shortage to damage the machine.

THE WATER STREAM CAN WASH THE DIRTY SURFACE OF THE TABLEWARE

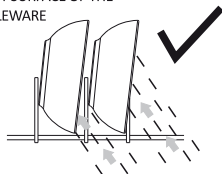

THE WATER STREAM CANNOT WASH THE DIRTY SURFACE OF THE TABLEWARE



THE TABLEWARE IS FULL OF WATER, AND THE DISHWASHER IS OUT OF WORK



3. The tableware cannot be stacked and placed. If the tableware is stacked and placed, The water flow cannot be washed in place, Which will cause the tableware to be unable To be washed.

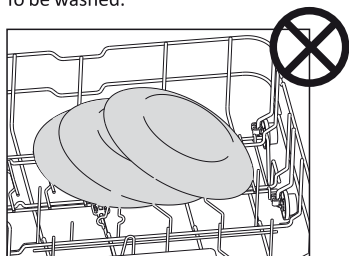

4. If large or dense tableware is placed under the cup holder, do not place larger tableware on the cup holder. The lower tableware will block the water flow and affect the cleaning effect of the tableware on the cup holder.

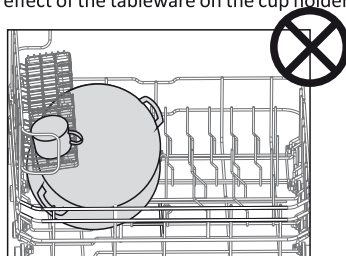

5. After the tableware is placed, please turn the spray arm to confirm that there is no tableware blocking the rotation of the spray arm. If utensils block the spray arm, the utensils will not be properly rinsed.

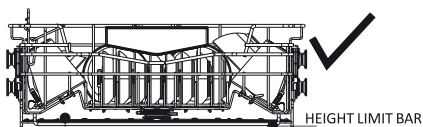

HEIGHT LIMIT BAR

MIDDLE SPRAY ARM

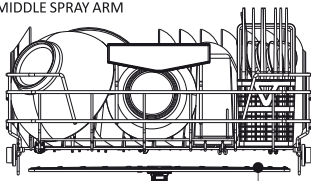

LOWER SPRAY ARM

6. There are limited height bars on both sides in front of the upper basket. When placing chopsticks and other high tableware in the lower basket, please do not exceed the height limit bar, otherwise it will affect the push and pull of the lower basket. Too high tableware will block the rotation of the middle spray arm and affect the tableware. cleaning effect. (See below)

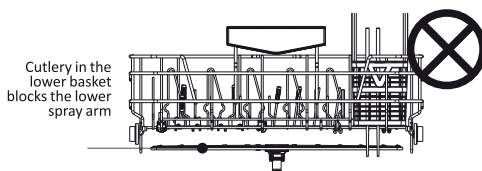

Cutlery in the lower basket blocks the lower spray arm

The middle spray arm is blocked by the tableware in the upper basket

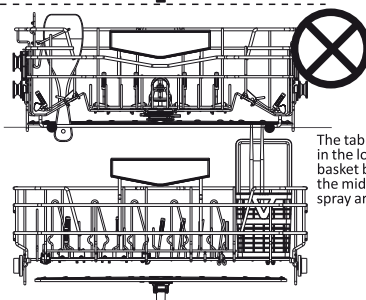

The tableware in the lower basket blocks the middle spray arm



If the situation shown in the right figure occurs, the spray arm cannot be rotated, which will affect the washing of the tableware!



## CLEANING AND MAINTENANCE

When doing any cleaning and maintenance, please disconnect the dishwasher from electricity (unplug the power cord) and water (turn off the water inlet valve/faucet).

### Holiday maintenance

If the dishwasher is not going to be used for an extended period of time, we recommend that you keep it dry, clean and empty.

Open the door slightly to keep the air circulation inside and outside. Turn off the dishwasher and the water inlet valve (tap).

When the dishwasher is used again after being idle for a long time, we recommend that you pour 3 cups of water into the dishwasher before use, in order to moisten the dry parts due to long-term non-use.

### Cleaning dishwasher surfaces

Wipe the surface of the dishwasher with a clean damp rag, then dry with a clean, lint-free cloth.

We recommend that you do not clean your dishwasher in the following ways, as this can damage the dishwasher:

1. Scrub with plastic or steel wool
2. Clean with abrasives, organic solvents or household cleaners
3. Clean with acidic or alkaline detergent
4. Wash with hand sanitizer or soap
5. Clean with stainless steel cleaner or polish
6. Clean the filter screen, spray arm and filter with washing powder or disinfectant.

### Cleaning filter units

Under normal use, it is recommended that you clean the manual filter (including the filter and filter) every three days (at least once a week), or when you find food residues on the filter, please clean it in time. After cleaning, install the filter in place as required.

1. Pull out the lower basket:

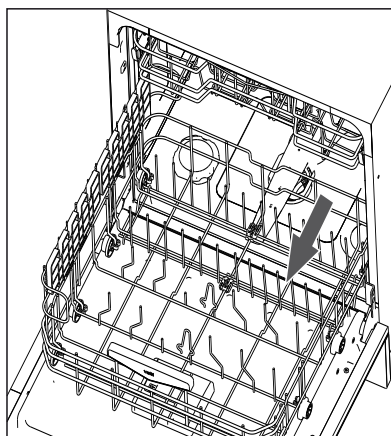

2. Rotate counterclockwise to unscrew and take out the filter, and take out the filter net;

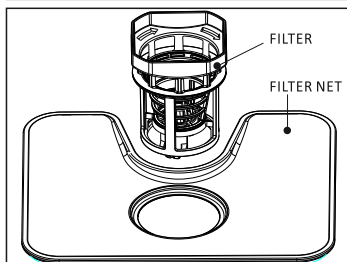
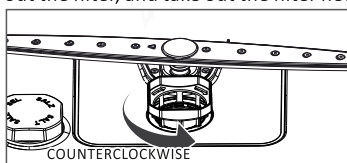



3. Rinse the filter and the residue on the filter net;

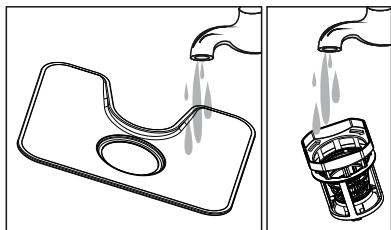

4. Put the filter back into the dishwasher filter slot (note: the filter must be inserted under the filter buckle to be fixed in place);

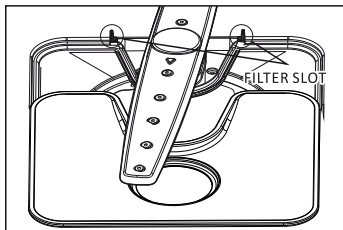

5. Reinstall the filter into the slot, press down vertically and turn clockwise until the filter is tightened.

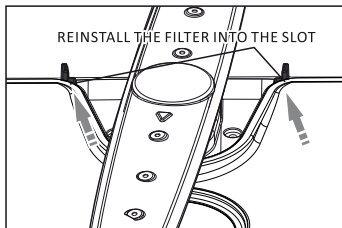
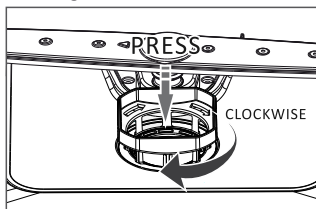

### Cleaning lower spray arm

1. Under normal use, the spray arm does not need to be cleaned frequently. If the hole on the spray arm is blocked by residue, please remove the spray arm and rinse it with clean water;
2. Grasp the middle connection position of the lower spray arm and pull it up, pull out the lower spray arm, and rinse out the food residue blocked in the hole of the spray arm;

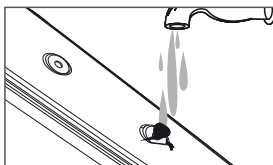
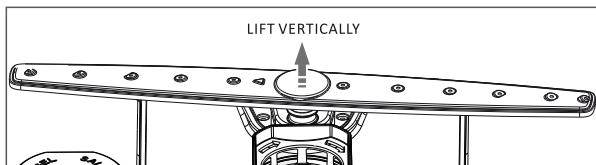

3. Align the shaft of the spray arm with the hole and press down vertically until a "click" sound is heard, and the buckle of the spray arm is fastened. Rotate the lower spray arm to verify that the spray arm is properly seated.

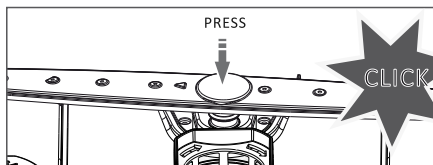
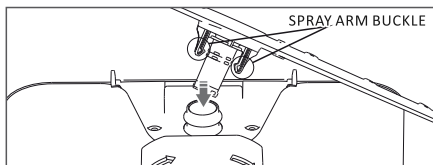

### NOTICE

- If you use dishwasher detergent or descaler to clean the dishwasher, you must run a random wash program after cleaning to prevent detergent residues from damaging the dishwasher.



## Cleaning door sealing strip and chassis

During the washing process, the spray arm may spray part of the residual powder into the sealing strip of the lower closing part of the dishwasher door, which cannot flow out or flows out slowly, resulting in the accumulation of stains on the sealing strip under the dishwasher door and the chassis. This is normal, and it is recommended to clean it once a week with a clean damp cloth.

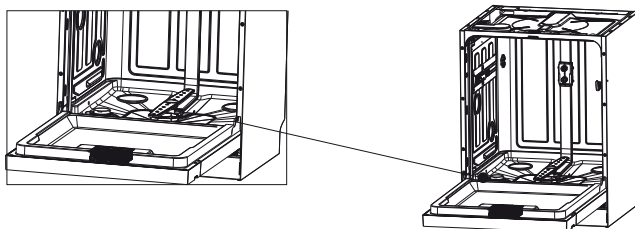

## FAULT IDENTIFICATION AND HANDLING

Fault prompt functions	Reasons	Solutions	Judgement logic
<b>E1</b>	Water inlet failure	1.Make sure the water inlet valve (tap) is open; 2.Please contact the manufacturer's after-sales service department for resolution	Procedure still not reached after 5 minutes of water intake Amount of water required.
<b>E2</b>	Temperature sensor failure	Please contact the manufacturer's after-sales service department for resolution	Abnormal temperature sensor (open or short circuit)
<b>E3</b>	Water overflow failure	1.Check that drains are not hanging too high. 2.Check that the drainage pipe is not kinked, or that it is blocked or pressed by a heavy object; 3.Contact the manufacturer's after sales service department to solve the problem decide	Water overflow switch triggered alarm
<b>E4</b>	Heater failure	Please contact the manufacturer's after-sales service department for resolution	After 20 minutes of heater operation, the temperature sensor detects that the temperature is not as high as it should be. Request for elevation



Fault prompt functions	Reasons	Solutions
Poorly washed dishes	Poorly arranged tableware: <ul style="list-style-type: none"> <li>● Tableware stacked on top of each other</li> <li>● The water flow is blocked by the cutlery under the cup holder, resulting in the cutlery on the cup holder not being washed.</li> <li>● Tableware not placed at an angle</li> </ul>	Refer to the instructions for proper tableware presentation
	Short selection procedure, not enough time for washing	A program of 1 hour or more is recommended
	dishes are not pre-treated for residue before being placed in the dishwasher and larger food residues are left in the basket, bottom of the dishwasher, strainer or filter	Dispose of larger residues before putting dishes in the dishwasher
	Too little dishwashing powder; use of poor quality dishwashing powder	<input type="checkbox"/> Dishwashing powder to match the contamination of the dishes <input checked="" type="checkbox"/> Use special dishwashing detergent purchased from proper sources
	The lid of the dishwashing powder compartment is not closed, resulting in the powder being placed in the pre-wash stage and no powder in the main wash stage	After adding the dishwashing powder, close the lid of the dishwashing powder container and make sure Buckle fastening
	The spray arm is blocked by the cutlery and cannot rotate the spray properly	Check that the cutlery is not blocked after each setting Rotation of the spray stop arm
	Spray arms not fitted in place, resulting in loose or non-rotating spray arms	Reinstall the spray arms and make sure the clips are tight
	Blocked spray arm holes	Clean the residue from the spray arm holes and properly Installation
	The filter is not installed in place, resulting in food residues entering the washing system and causing secondary contamination of the dishes	Clean the filter and screen and check that the spray arm holes are not blocked. Install the filter and screen correctly and ensure that the filter is tightened
	Filter clogged with residue	Clean the filter and make sure it is in place
	Surface residue on tableware is too dry and caked	Use the power wash program; soak dishes, manually Remove large surface residues before washing
	Some kinds of food are difficult to wash. Such as utensils for steaming eggs	Wash by hand and then put in the dishwasher with the rest of the dishes to sterilize
	Power failure during washing	Rerun the washing program
	Water stoppage or low water pressure during washing	Rerun the washing program
	Faulty heater, resulting in no heating, affecting the washing effect	Contact the manufacturer's after-sales service department for resolution
	Certain foods such as mustard, mayonnaise, lemon, vinegar, salt, salad dressing, etc. may cause stains on stainless steel if left too long. All stainless steel products that are picked up in the dishwasher during the cleaning process.	If you do not start the dishwasher immediately, please rinse off such food first and we recommend using the Quick Wash program To avoid leaving traces, it is necessary to combine the different metal.
	Touching the silver will leave spots on the silver or aluminiumThe product will also leave stains on the dishes	Made to separate bowls and plates. Such as silver, stainless steel or aluminium.





Fault prompt functions	Reasons	Solutions
White powder residue in the liner	<p>This powder may be white scale</p> <ul style="list-style-type: none"> <li>● Lack of special salt</li> <li>● Low soft water level, resulting in limescale</li> </ul>	<ol style="list-style-type: none"> <li>① Add special salt and make sure the water softener cap is tightened</li> <li>② Adjust the appropriate water softening level according to the local water hardness</li> <li>③ Use dishwasher body cleaner or food grade Descaling agent to clean limescale</li> </ol>
	The water softener cap was not tightened, causing the brine to leak and recrystallise into a white powder when dry	<ol style="list-style-type: none"> <li>① Use dishwasher body cleaner or food grade descaling agent to clean the limescale in the liner</li> <li>② Ensure that the water softener cap is tightened after adding the special salt</li> </ol>
	Dishwashing blocks were used in short time program such as cold rinse*, fruit and vegetable wash*, warm dishwashing* and quick wash, and the blocks did not dissolve completely	<ol style="list-style-type: none"> <li>① Cold rinsing*, fruit and vegetable washing* and warm dishwashing* procedures do not allow the use of dishwashing powder or dishwashing blocks</li> <li>② A small amount of dishwashing powder is sufficient for the quick wash program, a dishwashing block is not recommended</li> </ol>
	<ol style="list-style-type: none"> <li>① Dishwashing powder residue due to overdosing.</li> <li>② The spray arm holes are blocked, resulting in some of the dishwashing powder not being washed away by the water.</li> <li>③ Use poor quality dishwashing powder.</li> </ol>	<ol style="list-style-type: none"> <li>① Add the appropriate amount of dishwashing powder according to the level of contamination of the dishes.</li> <li>② Clean the spray arms and run the program again for more than 1 hour</li> <li>③ Use special dishwashing detergent bought from proper sources</li> </ol>
Tableware, inner wall is not dry	Water droplets in the basket, at the seams of the liner and on the spray arms	A small amount of water at the end of the program is normal.
	Use the "speed up" add-on to eliminate the drying of dishes	This procedure is normal, please take the dishes out in time after washing.
	No disc brightener added, out of dose indicator light on	Add dishwasher safe dish shine
	Use of all-in-one detergent, no dishwashing agent added, poor drying effect	Use an all-in-one detergent and add a dish shine to enhance the drying effect
	Dishes are not placed properly or not filled with cutlery	Refer to the instructions for proper tableware presentation
	Short drying times with short program washing	It is recommended to use a program of more than 1 hour for better drying results
	Some tableware such as wood and plastic tableware will take longer to dry due to the material	Waiting for longer drying times
	Washing program not finished	When the process has been completed properly
	Faulty bright disc adder, heater, affecting the drying effect	Contact the manufacturer's after-sales service department for resolution



Fault prompt functions	Reasons	Solutions
Foam residue in the liner	The glitter cap is not tightly closed, causing the glitter to leak	Tighten the lid of the dish shiner. Clean the liner foam
	The dishwashing block was used in the quick wash, cold rinse*, fruit and vegetable wash* and warm dishwashing* programs for a short time and the block did not dissolve completely	① Cold rinsing*, fruit and vegetable washing* and warm dishwashing* procedures do not allow the use of dishwashing powder or dishwashing blocks ② A small amount of dishwashing powder is sufficient for the quick wash programs, a dishwashing block is not recommended
	Use of poor quality dishwashing powder or bricks, or adding too much	Use special dishwashing powder or blocks purchased from regular sources and add them in moderation
	The process is not finished	Foam may be generated during the washing process, this is normal
	Use of detergent or other non-dishwasher safe detergents	① Dishwashers are not permitted to use detergents or other non-dishwasher safe cleaning agents ② Manually remove the foam and start any program for 3 minutes, end the program, wait until the drainage is finished and restart the program, repeat until the foam is flushed Clean
	Individual food residues may foam up during the washing process and be difficult to dissipate	Run the washing program again
No response press the key	Not powered on	Checking the power supply
	Oil or water on hands or glass	Clean hands or glass
	Door left open	Close the door tightly
	Faulty door sensor switch	Contact the manufacturer's after-sales service department for resolution
	Circuit board failure	① Turn the power off for 5 seconds and then turn it on to try ② Contact the manufacturer's after-sales service department to resolve the problem
Large amount of standing water left in dish washer	Drainage pump failure	Contact the manufacturer's after-sales service department for resolution
	Faulty water inlet valve	Contact the manufacturer's after-sales service department for resolution
	Kinked or blocked drainage pipes	Check the drains to ensure they are not blocked by bends
	Overhanging drainpipes	Refix the drain with reference to the drain installation position
	Dishwasher program not finished running	Continue running the dishwasher



Fault prompt functions	Reasons	Solutions
Water accumulation at the bottom of the filter, not in a dry state.	Insufficient dry time, water pooling at the bottom as part of the drain backflow; or residual water slipping from the basket or cutlery crevices	12-24 hours waiting time, with regular draining of water from the bottom to achieve a dry state
	Dry state program closed in custom mode, no dry state effect	Restarting dry state programs in custom mode
	Door opened during dry state, dry state program does not start	The dry state program continues to run after the door is closed
	The dishwasher control panel was operated during the dry state	After operation the program enters standby mode by default, stopping the dry state action, the cutlery can then be used normally
	Short duration and low temperature of the use procedure, not enough time and temperature for drying	Choose a program of 1 hour or more for better drying results
	Excessive extension of drainage pipes affecting drainage	Reduced drain distances
	Net discharge pump failure	Contact the manufacturer's after-sales service department for resolution
Impact sound during washing	Improperly placed dishes causing the spray arm to hit the cutlery as it rotates	Check that the cutlery is well placed and that it is not sticking out of the bottom of the basket blocking the spray arms.
The storage stage machine has a "Hoo Hoo" sound	Sound of the fan during the drying or air exchange phase	Normal. The "dry state" function can be switched off via a custom setting
Condensation around door panels	During the dishwasher drying process, the hot steam from the liner is exhausted outside the dishwasher through the fan and condenses into small water droplets when the room temperature is low	① Normal, expels hot steam, keeps dishes dry, prevents dampness and breeding of bacteria ② Before installing the dishwasher, apply the moisture-proof adhesive from the accessory pack around the cabinet mounting tabs to protect the cabinet effectively
On screen program indicator and time flashing	Door left open	Close the door tightly
	Faulty door sensor switch	Contact the manufacturer's after-sales service department for resolution

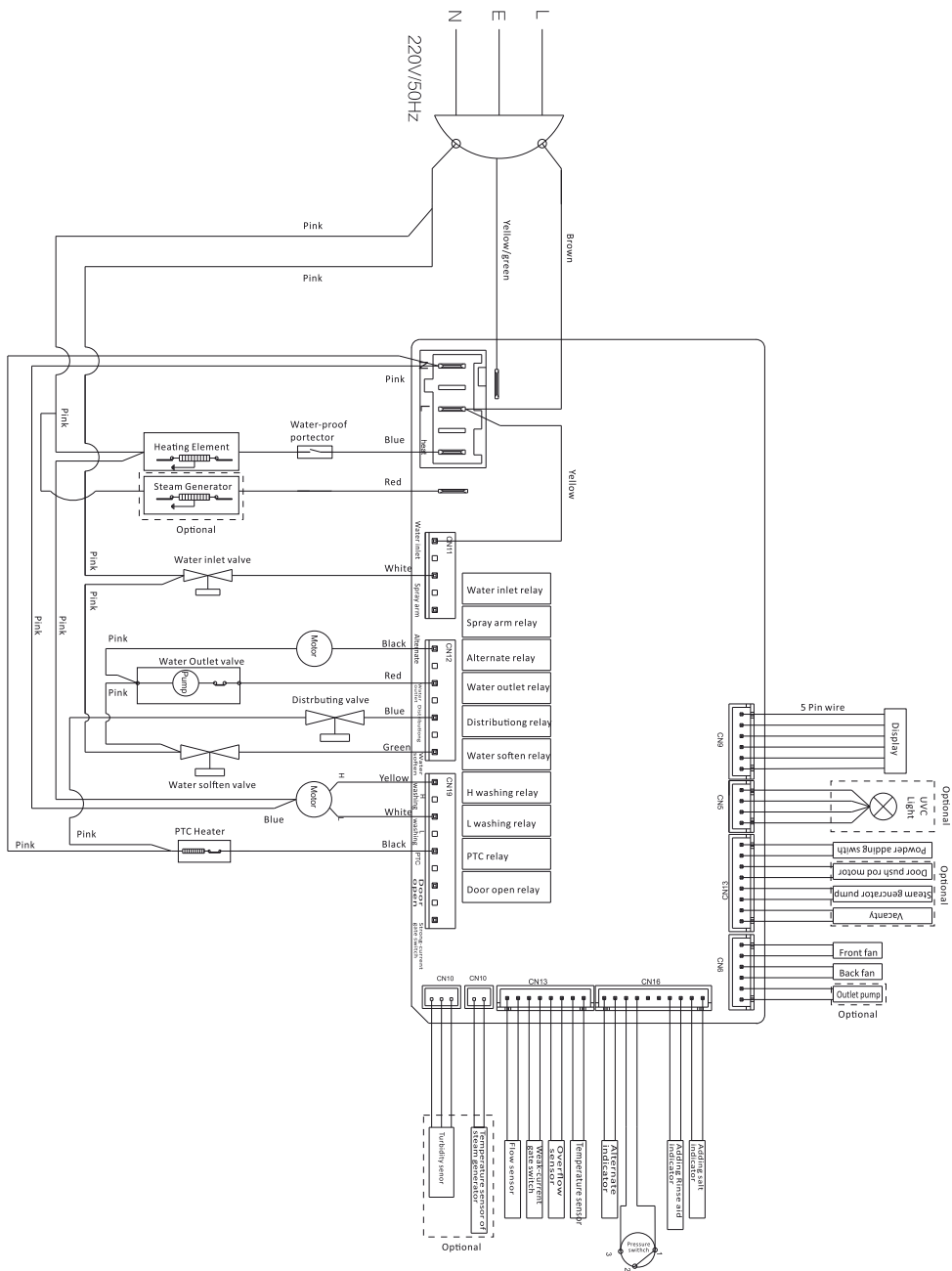





VATTI (M) SDN BHD  
202101045273 (1445573-P)  
Unit D5-08-01, Pusat Perdagangan Dana 1,  
Jalan PJU 1A/46, 47301 Petaling Jaya.  
[enquiry@vattimalaysia.com](mailto:enquiry@vattimalaysia.com)